

Photochemical Etching Design Guide

Photochemical etching, also known as photochemical machining (PCM), is an ideal process for manufacturing precision thin metal parts. The process utilizes chemicals to remove defined areas of masked sheet metal and enables us to deliver parts with complex or intricate geometries and tight tolerances.

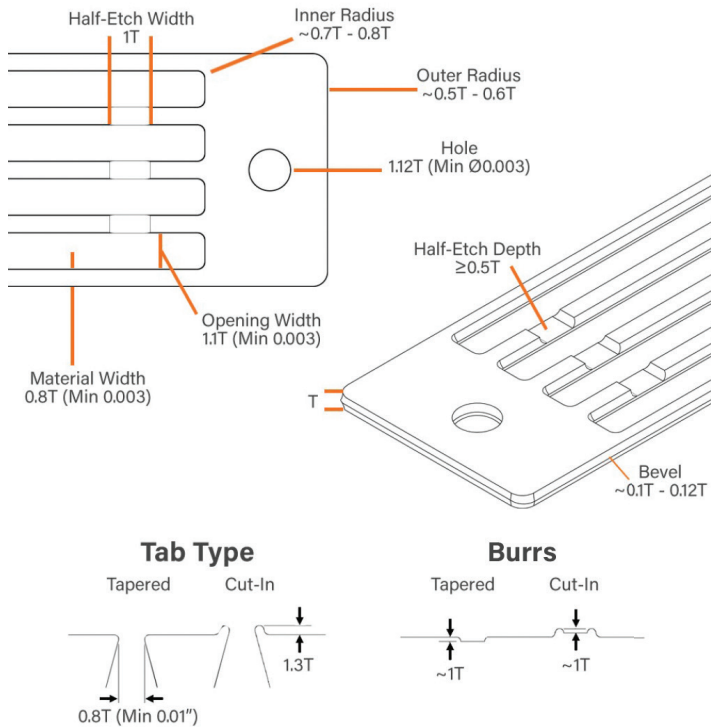

Experts in Etching

E-Fab pushes engineering and manufacturing boundaries to deliver parts that many other companies won't even try. We deliver precision, reliability, and durability with every part.

General Tolerances

± 10% material thickness no less than ± 0.0005"

Our Experience

We deliver stiffeners, busbars, flex circuits, micro bumps, encoders, circuits, antennas, shields, mesh screens, connectors, contacts, EMI/RFI shields, springs, and more.

We Serve

Aerospace, Military, Energy, Fuel Cells, Medical, Microwave, Semiconductor, Telecommunications, Automotive, Transportation, Agriculture, and more.

Our Certifications



ISO 9001:2015



ITAR

We are E-FAB

A TPC COMPANY
We are an expert team of engineers, manufacturers, and quality assurance specialists that deliver precision parts with ultimate accuracy. We serve technology companies, defense contractors, medical equipment manufacturers, and innovators from our Santa Clara, California headquarters.

Address

1075 Richard Avenue
Santa Clara, CA 95050
United States

Contact

Main Phone: (408) 727-5218
Toll Free: (800) 600-3322
Fax: (408) 988-3342
info@e-fab.com